

### The Characteristics Of Hydraulic Vise

- Can be used on Machining Center. Processes 2 to 3 workpieces at the same time, Reduces the processing time and difficulties.
- Able to clamp various work pieces, easy to handle, saves time and reduces processing costs.



### Hydraulic Booster System

Hydraulic Booster provides a steady clamping force against shocks and vibrations during the operations, since it fastens the work piece resiliently with an aid of the discsprings mounted inside.

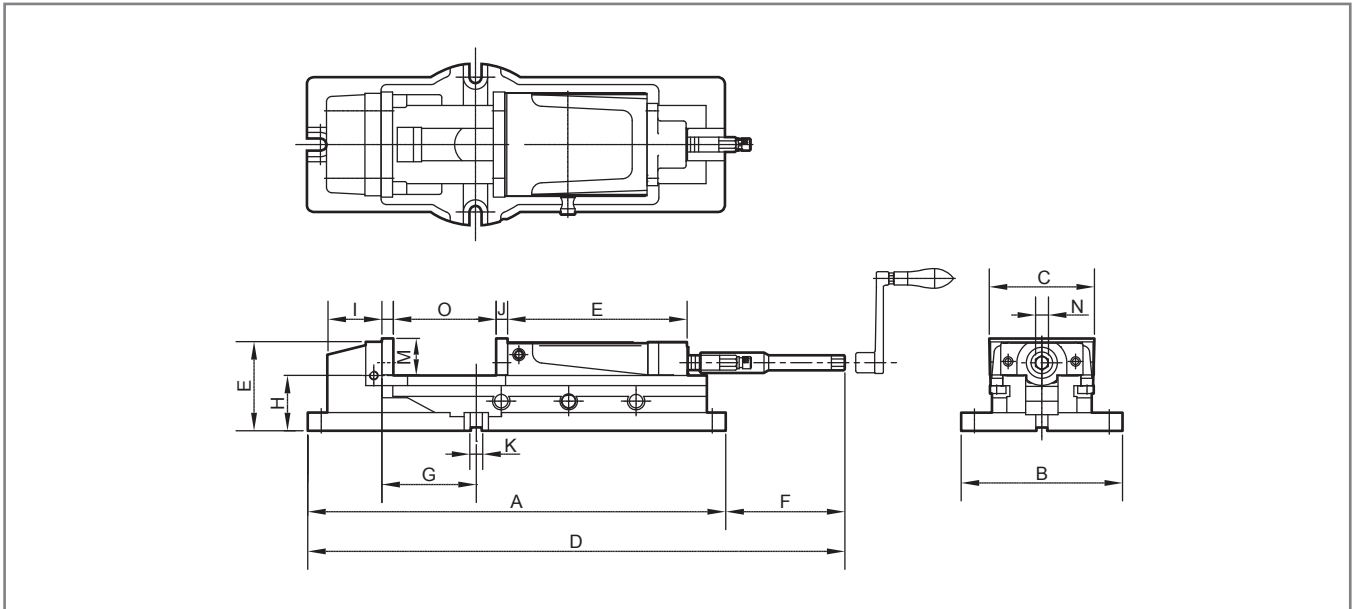

Order No.	A	B	C	D	E	F	G	H	I	J	K	L	M	N	O	Clamping Force	Weight
HP-40	435	160	104	525	93	90	53	58	76	11	16	153	36	14	170	25 KN	18 kg
HP-50	538	185	130	670	117	132	82	72	82	15	16	175	46	19	220	35 KN	28 kg
HP-60	620	240	154	800	132	180	140	82	81	17	16	208	54	19	300	44 KN	40 kg
HP-80	700	280	206	900	160	200	118	100	101	21	18	245	62	19	300	66 KN	82 kg